

**NOTICE OF VACANCY  
ON THE BOARD OF DIRECTORS  
OF THE FALLBROOK PUBLIC UTILITY DISTRICT FOR  
SUBDISTRICT NO. 1**

\*\*\*\*\*

**NOTICE IS HEREBY GIVEN** that effective July 22, 2019, a vacancy exists on the Board of Directors of the Fallbrook Public Utility District, Subdistrict No. 1, due to the resignation of Alvin W. Gebhart.

Persons interested in appointment to fill the vacancy in Subdistrict No. 1 must apply by filing a written Statement of Qualifications that includes their name, physical address, and contact information and a brief background of their education and experience to the District Secretary at the following address:

Fallbrook Public Utility District  
990 East Mission Road  
Fallbrook, CA 92028

Applications must be filed with the District Secretary no later than 5:00 p.m., Friday, August 16, 2019. Following the deadline for applications, the Board of Directors will interview qualified candidates. Interviews are anticipated to occur at a special Board meeting in late August and then appoint a Director to Subdistrict No. 1. The appointed Director will hold the Subdistrict No. 1 seat until the November 2020 election and may run for re-election in 2020 for the next four-year term.

To be eligible, qualified candidates must be eighteen years of age, a citizen of the State of California, a registered voter in the County of San Diego, and must reside within the boundaries of Subdistrict No. 1. A map of Subdistrict No. 1 is attached and is also available at [www.fpud.com](http://www.fpud.com) or the District's main office located at 990 East Mission Road, Fallbrook, California 92028.

For additional information, please contact Mary Lou West, District Secretary, at (760) 999-2704 or [maryloub@fpud.com](mailto:maryloub@fpud.com).

Executed this 23<sup>rd</sup> day of July, 2019, at Fallbrook, California.

  
\_\_\_\_\_  
Mary Lou West  
Secretary, Board of Directors  
Fallbrook Public Utility District

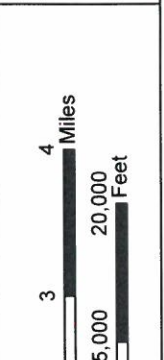
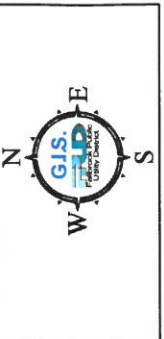
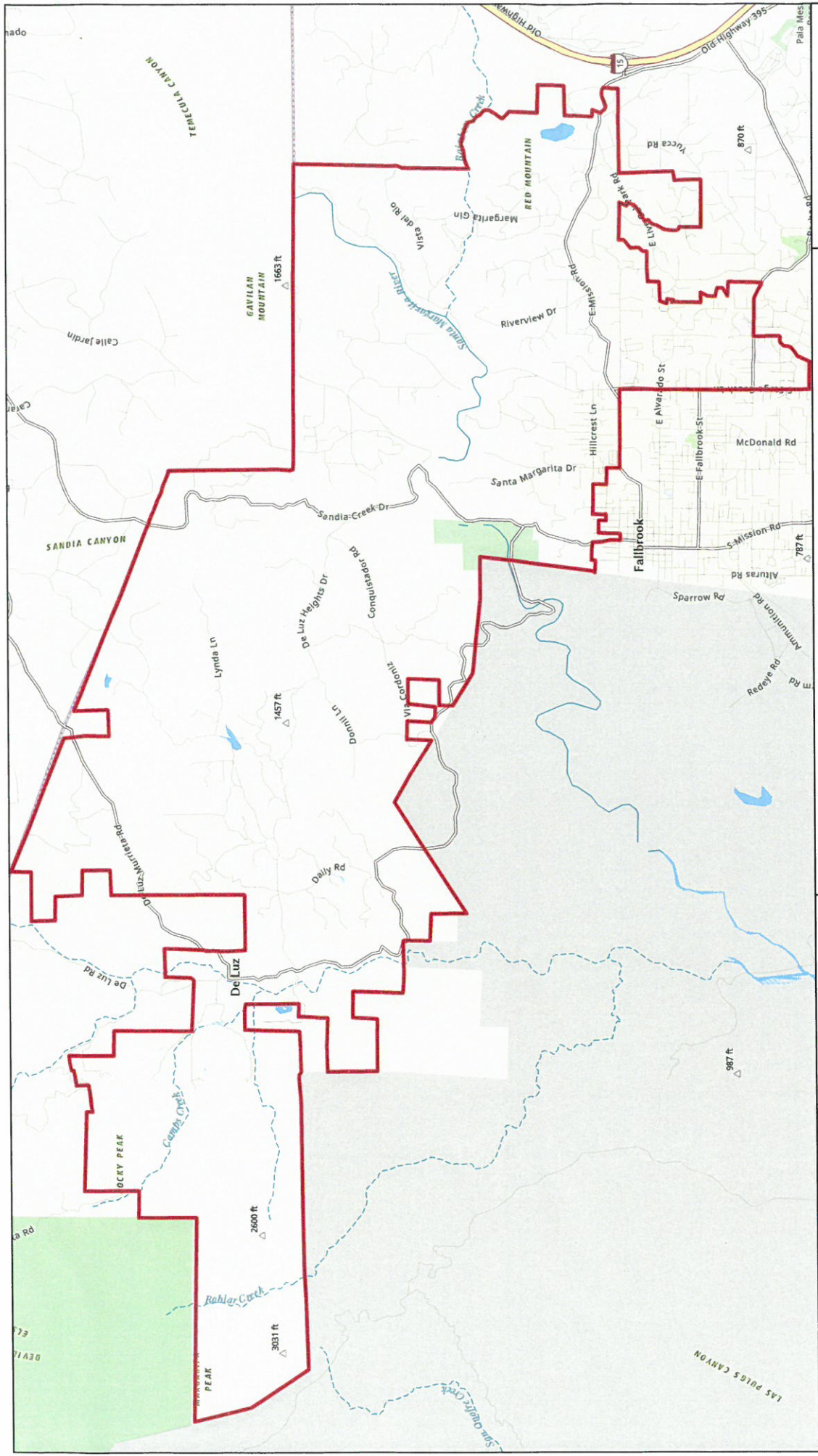

**DISTRICT 1**

0 0.5 1 2 3 4 Miles

0 2,500 5,000 10,000 15,000 20,000 Feet

Source: FWDIS, ESRI, Benchmark, California State Plane, Zone 8, NAD83, Feet, Epoch 1983, #E  
 Map Created by: Todd Jansen (TJansen139), X:\GIS\Data - Inside\Project\Special\Files for Use\DISTRICT\_1.MXD

**DIVISION 1**

**DISCLAIMER:** By accepting this map, you agree that the City of San Diego Public Utility District is not responsible for the accuracy or reliability of any data or calculations associated with this map. This map is provided without warranty of any kind.